

▼ Shown: **BV5 Hydraulic Bench Vise**



Safe, controlled, hands-free clamping



Hydraulic Bench Vise Sets

Order everything needed in one box to start working. The BV5 Hydraulic Bench Vise is available as a set (pump with gauge, tool, hose).

BV5 Set Model Number	Hydraulic Bench Vise Model	Pump Model Number	Coupler Model Number
STV5X	BV5*	XA11G	CR400

* Includes hydraulic hose HC7210.

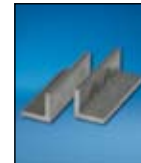

Magnetic Jaw Liners

Don't forget to order **BV5VC** Magnetic Jaw Liners. The magnet inserts hold steel objects like sockets, screws and rings.

Order model number¹⁾ **BV5VC**



Hydraulic Swivel Connector

An **XSC1** Hydraulic Swivel Connector allows optimal orientation of the Hydraulic Hose at the pump.

Order model number¹⁾ **XSC1**

¹⁾ Accessories must be ordered separately.

- 5-tons (44.5 kN) of force for forming and pressing applications
- 8-inch (203 mm) jaws hold large objects, making cumbersome tasks into one-person jobs
- Hands-free operation for safe and controlled actuation when paired with an Enerpac XA11G airpowered foot pump
- Flexible-use and ergonomically-friendly tool mounts as a press vertically or as a bench vise horizontally with a swivel base
- Rapid spring return makes repetitive work faster
- Accessory Magnetic Jaw Liners free hands by holding sockets, screws, rings, c-clips, springs, etc.
- Ships assembled with a heavy-duty 10-foot thermoplastic hydraulic hose, HC7210



Enerpac BV5 Hydraulic Bench Vise mounted vertically for high-force pressing applications. ►

◀ *Enerpac BV5 Hydraulic Bench Vise powered with an XA11G Foot Pump can change a traditional two-person job into a one-person operation.*



Hydraulic Bench Vise



Hydraulic Bench Vise

The Hydraulic Bench Vise is a general purpose tool that can have multiple clamping and holding applications. Its hydraulic cylinder applies force of up to 5 tons (44.5 kN), three-to-five times the force of a manually operated vise. Hydraulic pressure closes the vise, and spring-return opens the jaws. By pairing the Hydraulic Bench Vise with an Enerpac XA11G air-powered hydraulic power unit, the user can actuate the vise with the foot pedals while using both hands to perform work. In holding large objects, this can enable an otherwise cumbersome task to become a fast and easy one-person job. In addition, the XA11G provides the

control for the Hydraulic Bench Vise to hold even delicate objects without crushing. The integrated gauge of the XA11G provides clear indication of system status for better control of the tool. The Hydraulic Bench Vise can be installed horizontally on a flat surface, vertically as a press, or in any other orientation that satisfies the safety criteria stipulated by the operators' manual.

BV5 Series



Maximum Force:

5 tons

Maximum Jaw Opening:

8 inches

Jaw Width:

8 inches

Maximum Operating Pressure:

10,000 psi

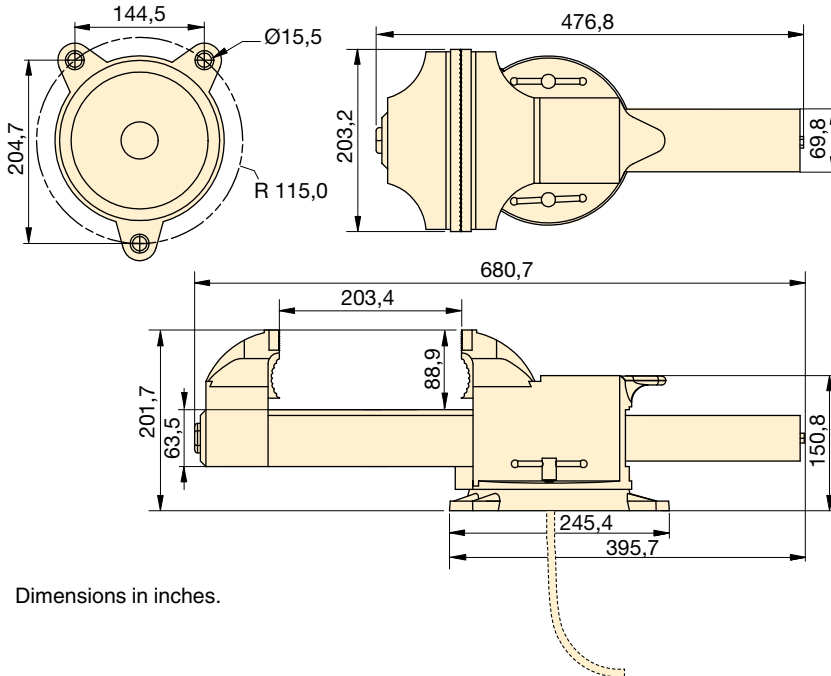

Dimensions in inches.

▼ Enerpac BV5 Hydraulic Bench Vise with hands-free XA11G Foot Pump for safe and controlled actuation.



SELECTION CHART

Maximum Force (10,000 psi)	Model Number	Oil Capacity	Height	Jaw Width	Jaw Opening (Fully Open)	Length (Jaws Closed)	Length (Jaws Open)	Weight (Vise only)
(ton)		(in ³)	(in)	(in)	(in)	(in)	(in)	(lbs)
44.5	BV5	131	202	203	203	477	680	25