

Shown: GS-2, G-2512L, GS-3



Enerpac gauges provide a safe and inexpensive monitoring system for your hydraulic circuit

Highly reliable and accurate pressure sensing

- $\pm 1.5\%$ accuracy of full scale
- All pressure sensing parts sealed and dampened by glycerine for long life
- Includes safety blow-out disk and pressure equalizing membrane to prevent overpressurization
- Copper alloy, coiled safety Bourdon tube for 1000 psi and higher
- Dual psi and bar scale readings, 2.5 inch gauge face

Gauge accessories for easy installation

- Needle valves providing positive shut-off
- 303 stainless steel stem (NV-25)
- Snubber valves to control pressure surges between gauge and hydraulic system
- Gauge adaptors – male end screws into pump or cylinder, female port accepts hose or coupler, the third port is for gauge connection
- FM-25NG for panel mounting of 2.50 inch diameter gauges

Product selection

Pressure gauge mounting style	Pressure range		Model number	PSI graduation		Bar graduation		A in	B in	D in	G
	psi	bar		Major psi	Minor psi	Major bar	Minor bar				
▼ Pressure gauge – Lower mount											
	0-100	0-7	G-2509L	10	2	1	0.01	3.31	1.46	2.50	1/4" NPT
	0-160	0-11	G-2510L	10	2	1	0.02	3.31	1.46	2.50	1/4" NPT
	0-200	0-14	G-2511L	50	5	1	0.02	3.31	1.46	2.50	1/4" NPT
	0-300	0-20	G-2512L	50	5	5	0.05	3.31	1.46	2.50	1/4" NPT
	0-600	0-40	G-2513L	100	10	10	1	3.31	1.46	2.50	1/4" NPT
	0-1000	0-70	G-2514L	100	20	10	1	3.31	1.46	2.50	1/4" NPT
	0-2000	0-140	G-2515L	500	50	10	2	3.31	1.46	2.50	1/4" NPT
	0-3000	0-200	G-2516L	500	50	50	5	3.31	1.46	2.50	1/4" NPT
	0-6000	0-400	G-2517L	1000	100	100	10	3.31	1.46	2.50	1/4" NPT
	0-10,000	0-700	G-2535L	2000	200	100	10	3.31	1.46	2.50	1/4" NPT
	0-1000	0-70	G-2514SL	100	20	10	1	3.66	1.23	2.50	SAE#4
	0-3000	0-200	G-2516SL	500	50	50	5	3.66	1.23	2.50	SAE#4
	0-6000	0-400	G-2517SL	1000	100	100	10	3.66	1.23	2.50	SAE#4
	0-10,000	0-700	G-2535SL	2000	200	100	10	3.66	1.23	2.50	SAE#4
▼ Pressure gauge – Rear mount											
	0-1000	0-70	G-2531R	100	20	10	1	2.48	1.46	2.50	1/4" NPT
	0-6000	0-400	G-2534R	1000	100	100	10	2.48	1.46	2.50	1/4" NPT
	0-10,000	0-700	G-2537R	2000	200	100	10	2.48	1.46	2.50	1/4" NPT
	0-1000	0-70	G-2531SR	100	20	10	1	2.46	1.23	2.50	SAE #4
	0-3000	0-200	G-2533SR	500	50	50	5	2.46	1.23	2.50	SAE #4
	0-6000	0-400	G-2534SR	1000	100	100	10	2.46	1.23	2.50	SAE #4
	0-10,000	0-700	G-2537SR	2000	200	100	10	2.46	1.23	2.50	SAE #4
	0-1000	0-70	1531R	100	20	10	1	1.99	0.98	1.50	1/8" NPT
	0-3000	0-200	1533R	500	100	50	10	1.99	0.98	1.50	1/8" NPT
	0-6000	0-400	1534R	1000	100	100	10	1.99	0.98	1.50	1/8" NPT
	0-10,000	0-700	1537R	2000	200	100	10	1.99	0.98	1.50	1/8" NPT

Swing cylinders
Work supports

Linear cylinders

Power sources

Valves

System components

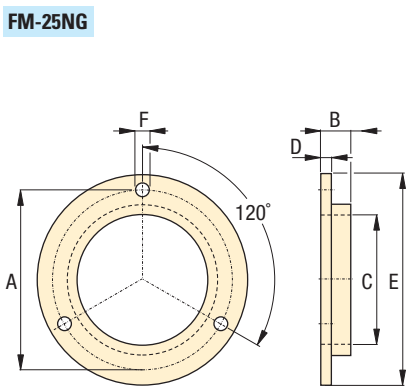
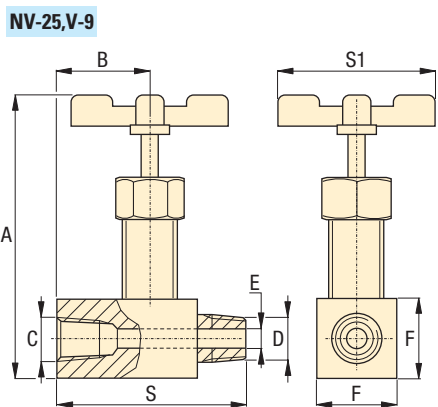
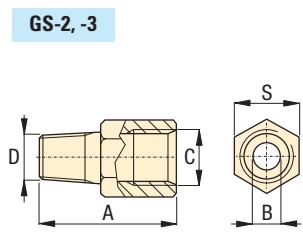
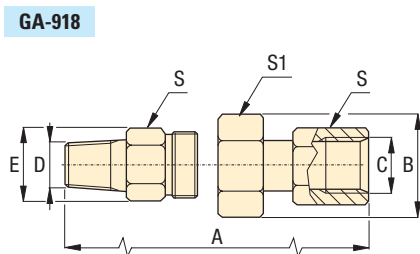
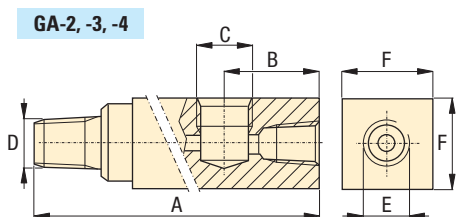
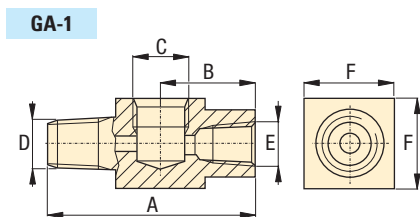

Pressure: 0-10,000 psi
 Accuracy: 1.5% /full scale
 Gauge face: ø 2.5 inch

- E** Manómetros
- F** Manomètres
- D** Manometer



Options

Hoses and couplers 
 156 ▶

Digital gauges 
 153 ▶

Pressure switches 
 152 ▶

V-10 Auto Damper® valve 
 140 ▶

Important

Do not exceed maximum pressure.

Gauge snubbers or needle valves are recommended for high cycle applications.

Do not keep gauges under permanent pressure. The use of shut-off valves is recommended.

For basic system set-up information, refer to our "Yellow Pages" section.
 161 ▶

Product dimensions in inches []

Gauge port NPT	Max. pressure psi	Model number	Dimensions							
			A	B	C	D	E	F	S	S1
▼ Gauge adaptors										
1/2"	10,000	GA-1	2.81	1.24	1/2"NPT	3/8"NPT	3/8"NPT	1.25	-	-
1/2"	10,000	GA-2	6.10	1.38	1/2"NPT	3/8"NPT	3/8"NPT	1.25	-	-
1/4"	10,000	GA-3	5.25	1.38	1/4"NPT	3/8"NPT	3/8"NPT	1.25	-	-
1/2"	10,000	GA-4	4.38	1.38	1/2"NPT	1/4"NPT	3/8"NPT	1.25	-	-
▼ Swivel gauge adaptor										
1/2"	10,000	GA-918	2.25	1.72	1/2"NPT	1/2"NPT	1.30	-	1.13	1.50
▼ Gauge shut-off valves										
1/4"	10,000	NV-25	3.50	1.06	1/4"NPT	1/4"NPT	2.50	.88	2.13	2.50
1/2"	10,000	V-9	3.63	1.25	1/2"NPT	1/2"NPT	2.50	1.00	2.13	2.50
▼ Gauge snubber valves										
1/4"	5000	GS-2	1.63	.018	1/4"NPT	SAE #4	-	-	.75	-
1/4"	5000	GS-3	1.63	.018	1/4"NPT	G1/4"	-	-	.75	-
▼ Flange mounting for panel mounting of G series gauges										
-	-	FM-25NG	2.95	.17	2.51	.07	3.35	.14	-	-

System components
Yellow pages