





















Pumps and Directional Control Valves Section Overview

| Power Source | Pump Types | Maximum Reservoir Capacity | Max. Flow at Rated Pressure (in ³ /min) | Series | | Page |
|-----------------------------------|--|----------------------------|--|-------------|---|-------|
| Manual | Lightweight Hand Pumps Exclusively from Enerpac | 155 in ³ | .15 (in ³ /stroke) | P |  | 62 ▶ |
| | Steel Hand Pumps | 453 in ³ | .29 | P |  | 64 ▶ |
| | Low Pressure Hand Pumps | 200 in ³ | .58 (in ³ /stroke) | P |  | 66 ▶ |
| | Foot Pump For Hands Free Operation | 38 in ³ | .15 (in ³ /stroke) | P |  | 68 ▶ |
| | Multifluid Hand Pumps Pumping Fluids up to 14,500 psi | 38 in ³ | 1.28 (in ³ /stroke) | MP |  | 69 ▶ |
| | Ultra-High Pressure Hand Pumps Pressure up to 40,000 psi | 60 in ³ | .15 (in ³ /stroke) | P/11 |  | 70 ▶ |
| Electric | Battery Powered Hydraulic Pump Cordless Hydraulic Power | 1 gal. | 15 | BP |  | 72 ▶ |
| | Economy Series Compact and Portable | 1 gal. | 20 | PU |  | 74 ▶ |
| | Submerged Series Powerful and Low-Noise | 1.5 gal. | 20 | PE |  | 76 ▶ |
| | Z-Class Pumps, ZU4 and ZE3 to ZE6-Series Portable and Powerful | 10 gal. | 60 200 | ZU ZE |  | 82 ▶ |
| | 8000-Series The Maximum Flow Pump | 25 gal. | 462 | PE |  | 94 ▶ |
| Air | XA-Series XVARI® Technology for Productivity and Ergonomics | 122 in ³ | 15 | XA |  | 96 ▶ |
| | Turbo II Air Hydraulic Pumps Compact Air Over Hydraulic | 305 in ³ | 10 | PA |  | 98 ▶ |
| | Air Hydraulic Pumps Single and Twin-Air Motor | 2 gal. | 9 | PA PAM |  | 100 ▶ |
| | ZA4 Air Hydraulic Pumps The Standard for Air-Hydraulic Pumps | 10 gal. | 80 | ZA |  | 102 ▶ |
| | ATP-Series Air Pump High Pressure Air Pump | 1 gal. | 4 | ATP |  | 104 ▶ |
| Gasoline | Atlas Series Small and Lightweight | 2 gal. | 40 | PGM |  | 105 ▶ |
| | ZG5/ZG6 Gasoline Hydraulic Pumps Gas Powered High Flow Pumps | 10 gal. | 200 | ZG5/ ZG6 |  | 106 ▶ |
| | 8000-Series Gasoline Pumps For the Largest Jobs | 25 gal. | 1.5 (gal/min) | EGM |  | 108 ▶ |
| Directional Control Valves | | | | |  | 109 ▶ |

▼ Pumps shown, from top to bottom: P-802, P-842, P-202, P-142



- Lightweight and compact design
- Durable glass-filled nylon reservoir and nylon encapsulated aluminum pump base for maximum corrosion resistance
- Two-speed operation on most models reduces handle strokes by as much as 78% over single speed pumps
- Lower handle effort to minimize operator fatigue
- Integral 4-way valve on P-842 for operation of double-acting cylinders
- Handle lock and lightweight construction for easy carrying
- Large oil capacities to power a wide range of cylinders or tools
- Non-conductive fiberglass handle for operator safety
- Internal pressure relief valve for overload protection

▼ P-392 in action with RSM-500 cylinders.



Exclusively from Enerpac

i **Cylinder Matching Chart**
For help in selecting the correct hand pump for your application, please refer to the Cylinder Matching Chart located in the “Yellow Pages”.
Page: 244

i **Speed Chart**
To determine how a specific pump will operate your cylinder, see the Pump/Cylinder Speed Chart in the “Yellow Pages”.
Page: 251

 **Tank Kits**
When a return-to-tank port is required, the Tank Kits provide a 7/16-20 port at the rear of the reservoir.

| | |
|--------------|--------------------------|
| PC-20 | Fits P-141, P-142 |
| PC-25 | Fits P-202, P-391, P-392 |

 **LX-101 Hand Pump Oil**
A medium viscosity oil specially formulated for hand pumps. Performs well in low temperatures and requires less pumping effort than standard Enerpac HF blue oil.
Page: 122

| Pump Type | Usable Oil Capacity (in ³) | Model Number | Pressure Rating* | | Oil Displacement per Stroke | | Max. Handle Effort (lbs) |
|--------------|---|--------------|-----------------------|-----------------------|-----------------------------|-----------------------|-----------------------------|
| | | | (psi) | | (in ³) | | |
| | | | 1 st stage | 2 nd stage | 1 st stage | 2 nd stage | |
| Single-speed | 20 | P-141 | N/A | 10,000 | N/A | .055 | 72 |
| | 55 | P-391 | N/A | 10,000 | N/A | .151 | 85 |
| Two-speed | 20 | P-142** | 200 | 10,000 | .221 | .055 | 78 |
| | 55 | P-202 | 200 | 10,000 | .221 | .055 | 63 |
| | 55 | P-392** | 200 | 10,000 | .687 | .151 | 93 |
| | 155 | P-802 | 400 | 10,000 | 2.40 | .151 | 95 |
| | 155 | P-842*** | 400 | 10,000 | 2.40 | .151 | 95 |

* Contact Enerpac for applications where operating pressure is less than 10% of pressure rating.
** Available as set, see note on top of next page.
*** For use with double-acting cylinders.

Lightweight Hand Pumps

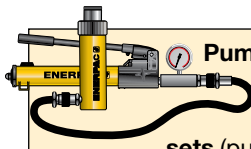

Pump and Cylinder Sets
Pumps marked with an ** are available as sets (pump, cylinder, gauge, couplers and hose) for your ordering convenience.

Page: 58

P Series



Reservoir Capacity:
20-155 in³

Flow at Rated Pressure:
.055-.15 in³/stroke

Maximum Operating Pressure:
10,000 psi



Hoses

Enerpac offers a complete line of high-quality hydraulic hoses. To ensure the integrity of your system, specify only genuine Enerpac hydraulic hoses.

Page: 118



Gauges

Minimize the risk of overloading and ensure long, dependable service from your equipment. Refer to the System Components section for a full range of gauges.

Page: 117



Aluminum Reservoir

For applications where composite reservoirs may not be suitable, the P-392AL utilizes an extruded aluminum reservoir. Also included is a second handle for two-hand use. Contact Enerpac for details.

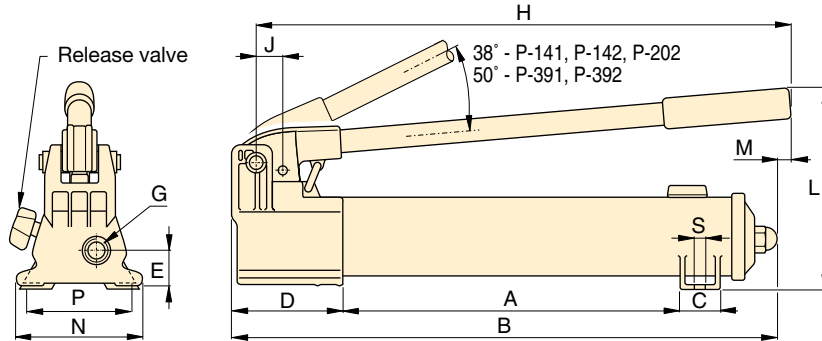

P-141, P-142, P-202, P-391, P-392

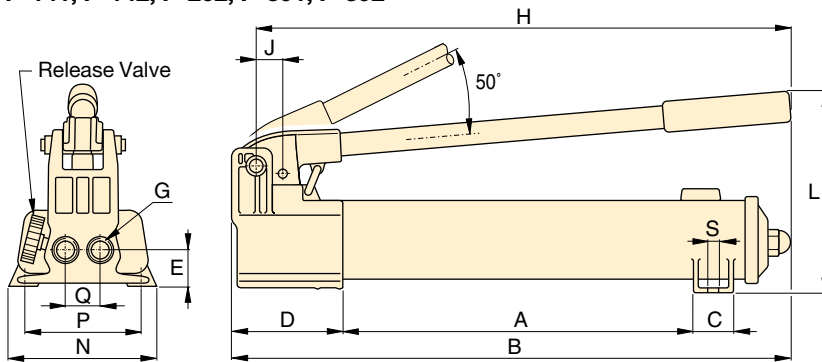

P-802

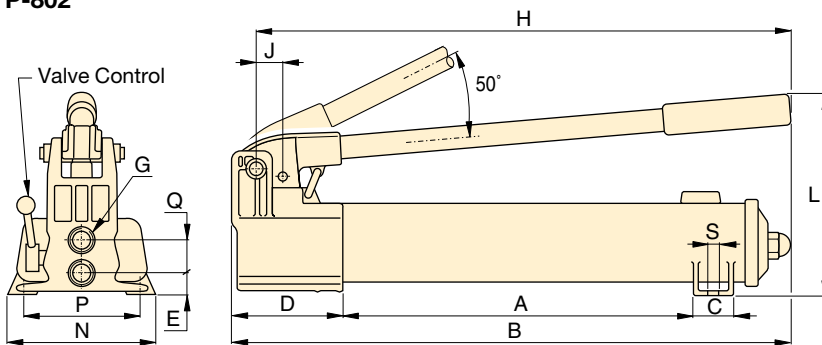

P-842

| Piston Stroke | Dimensions (in) | | | | | | | | | | | | | | | Weight (lbs) | Model Number |
|---------------|-----------------|-------|------|------|------|--------------|-------|------|------|-----|------|------|------|-----|------|--------------|--------------|
| | (in) | A | B | C | D | E | G | H | J | L | M | N | P | Q | S | | |
| .50 | 7.31 | 13.25 | 1.13 | 3.37 | 1.13 | 1/4"-18 NPTF | 12.56 | .75 | 5.63 | - | 3.75 | 3.25 | - | .28 | 5.3 | P-141 | |
| 1.00 | 13.56 | 21.00 | 1.44 | 3.93 | 1.31 | 3/8"-18 NPTF | 20.56 | 1.19 | 7.00 | .63 | 4.75 | - | - | - | 9.0 | P-391 | |
| .50 | 7.31 | 13.25 | 1.13 | 3.37 | 1.13 | 1/4"-18 NPTF | 12.56 | .75 | 5.63 | - | 3.75 | 3.25 | - | .28 | 5.3 | P-142** | |
| .50 | 13.56 | 20.06 | 1.44 | 3.37 | 1.13 | 1/4"-18 NPTF | 15.75 | .75 | 5.69 | .63 | 3.75 | - | - | - | 7.5 | P-202 | |
| 1.00 | 13.56 | 21.00 | 1.44 | 3.93 | 1.31 | 3/8"-18 NPTF | 20.56 | 1.19 | 7.00 | .63 | 4.75 | 4.75 | - | - | 9.0 | P-392** | |
| 1.00 | 13.30 | 21.75 | 1.78 | 5.25 | 1.39 | 3/8"-18 NPTF | 20.75 | 2.19 | 9.00 | - | 7.12 | 4.75 | 1.40 | .41 | 18.0 | P-802 | |
| 1.00 | 13.30 | 21.75 | 1.78 | 5.25 | .81 | 3/8"-18 NPTF | 20.75 | 2.19 | 9.00 | - | 7.12 | 4.75 | 1.44 | .41 | 22.0 | P-842** | |

▼ Shown from left to right: P-462, P-84, P-801, P-77, P-80, P-39



- Two-speed operation for reduced operator fatigue (except P-39)
- 4-way valving on the P-84 and P-464 for operation of double-acting cylinders
- External load release valve on remaining models for single-acting cylinder operation
- Internal pressure relief valve for overload protection
- Large oil capacity to power a wide range of cylinders or tools

▼ In the absence of a power supply, the P-80 Hand Pump offers a powerful solution.



The Solution for Tough Jobs



Two Speed

Recommended for applications where cylinder plunger must advance rapidly to contact load, and applications where greater oil capacities are required, such as multiple cylinder hook-ups.



Foot Pump Conversion Kits

Convert your P-39 to foot power with the PC-10 Kit. Includes instructions for easy conversion.



Gauges

Minimize the risk of overloading and ensure long, dependable service from your equipment. Refer to the System Components section for a full range of gauges.

Page: 117



4-Way Control Valve

P-84 and P-464 feature a manual 4-way control valve, designed for use with one double-acting or two single-acting cylinders. For system set-up information:

Page: 247

| Pump Type | Usable Oil Capacity (in ³) | Model Number | Pressure Rating* | | Oil Displacement per Stroke (in ³) | | Max. Handle Effort (lbs) |
|-----------|---|--------------|-----------------------|-----------------------|---|-----------------------|-----------------------------|
| | | | (psi) | | (in ³) | | |
| | | | 1 st stage | 2 nd stage | 1 st stage | 2 nd stage | |
| Single | 40 | P-39 | N/C | 10,000 | N/C | .16 | 111 |
| Two-speed | 47 | P-77 | 200 | 10,000 | .97 | .15 | 94 |
| | 134 | P-80** | 350 | 10,000 | .99 | .15 | 104 |
| | 249 | P-801 | 350 | 10,000 | .99 | .15 | 104 |
| | 134 | P-84*** | 350 | 10,000 | .99 | .15 | 104 |
| | 453 | P-462 | 200 | 10,000 | 7.69 | .29 | 110 |
| | 453 | P-464*** | 200 | 10,000 | 7.69 | .29 | 110 |

* Contact Enerpac for applications where operating pressure is less than 10% of pressure rating.

** Available as a set, see note on next page.

*** For use with double-acting cylinders.

Steel Hand Pumps

P Series



Reservoir Capacity:
40-453 in³

Flow at Rated Pressure:
.15-.29 in³/stroke

Maximum Operating Pressure:
10,000 psi

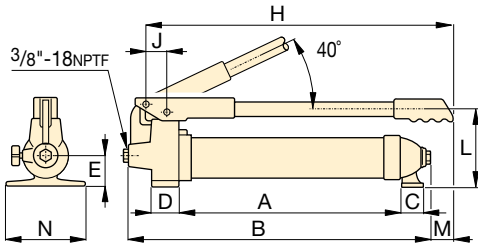

P-39, P-77

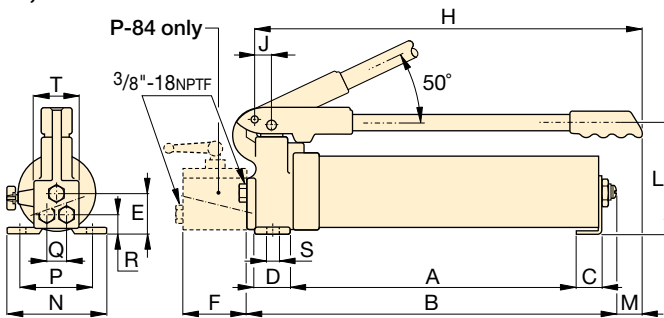

P-80, P-801, P-84

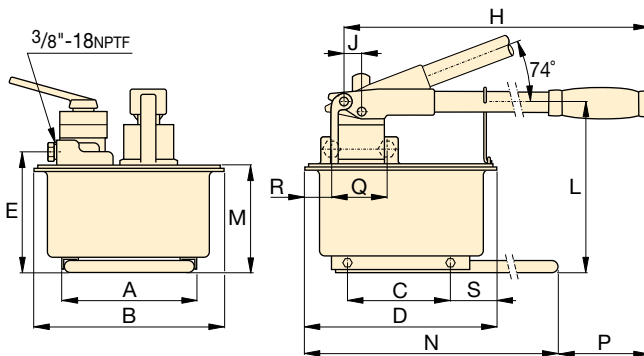

P-462, P-464

Pump and Cylinder Sets
P-80 is also available as a set (pump, cylinder, gauge, couplers and hose) for your ordering convenience.

Page: 58

Speed Chart
To determine how a specific pump will operate your cylinder, see the Pump/Cylinder Speed Chart in the "Yellow Pages".

Page: 251

Cylinder Matching Chart
For help in selecting the correct hand pump for your application, please refer to the Cylinder Matching Chart located in the "Yellow Pages."

Page: 244

| Piston Stroke | Dimensions (in) | | | | | | | | | | | | | | | | | Weight (lbs) | Model Number |
|---------------|-----------------|-------|------|-------|------|------|-------|------|-------|------|------|------|------|------|------|------|---|--------------|--------------|
| | (in) | A | B | C | D | E | F | H | J | L | M | N | P | Q | R | S | T | | |
| .81 | 15.50 | 20.47 | 1.28 | 1.50 | 1.25 | - | 18.25 | 1.18 | 4.69 | 2.56 | 5.25 | - | - | - | - | - | - | 13 | P-39 |
| 1.00 | 16.46 | 20.67 | 1.30 | 1.57 | 2.04 | - | 22.04 | 1.34 | 4.57 | 1.97 | 4.72 | - | - | - | - | - | - | 15 | P-77 |
| 1.00 | 16.75 | 21.22 | 1.00 | 1.75 | 2.13 | - | 20.75 | 1.14 | 6.88 | .75 | 5.75 | 4.76 | - | .83 | .31 | - | - | 24 | P-80** |
| 1.00 | 25.94 | 30.78 | 1.00 | 1.75 | 2.13 | - | 30.43 | 1.14 | 6.88 | - | 5.75 | 4.76 | - | .83 | .31 | - | - | 31 | P-801 |
| 1.00 | 16.75 | 21.22 | 1.00 | 1.75 | - | 2.52 | 20.75 | 1.14 | 6.88 | .75 | 5.75 | 4.76 | 1.50 | 1.69 | .31 | 2.64 | - | 29 | P-84*** |
| 1.50 | 8.25 | 12.13 | 6.42 | 12.63 | 7.68 | - | 26.44 | .98 | 10.63 | 6.89 | 25.6 | 3.63 | - | - | 3.13 | - | - | 61 | P-462 |
| 1.50 | 8.35 | 12.13 | 6.42 | 12.63 | 7.68 | - | 26.44 | .98 | 10.63 | 6.89 | 25.6 | 3.63 | 3.50 | 2.68 | 3.13 | - | - | 61 | P-464*** |

▼ Shown from left to right: P-25, P-51, P-18



When Less Than 10,000 psi is All You Need

- P-25 and P-50 pump oil in both forward and reverse handle movement improving overall efficiency, ideal when mounting space is restricted
- External load-release valve
- Internal pressure-relief valve for overload protection
- P-51 can be operated in horizontal and vertical position with pump head and oil outlet facing downwards



LX-101 Hand Pump Oil

A medium viscosity oil specially formulated for hand pumps. Performs well in low temperatures and requires less pumping effort than standard Enerpac HF blue oil.

Page: 122



Gauges

Minimize the risk of overloading and ensure long, dependable service from your equipment. Refer to the System Components section for a full range of gauges.

Page: 117

▼ P-18 hand pump used for locking the rotating table for marble polishing.



| Pump Type | Usable Oil Capacity (in ³) | Model Number | Pressure Rating (psi) | Oil Displacement per Stroke (in ³) | Max. Handle Effort (lbs) |
|--------------|---|--------------|--------------------------|---|-----------------------------|
| Single-speed | 18 | P-18 | 2,850 | 0.16 | 57 |
| | 200 | P-25 | 2,500 | 0.58 | 60 |
| | 200 | P-50 | 5,000 | 0.29 | 60 |
| | 50 | P-51 | 3,000 | 0.25 | 61 |

Low Pressure Hand Pumps

P Series



Reservoir Capacity:
18-200 in³

Flow at Rated Pressure:
.16-.58 in³/stroke

Maximum Operating Pressure:
2,500-5,000 psi

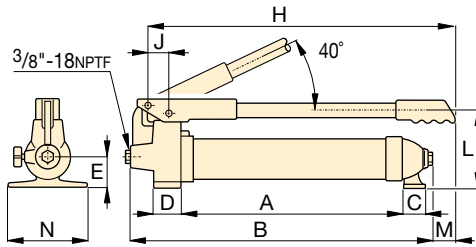

P-18

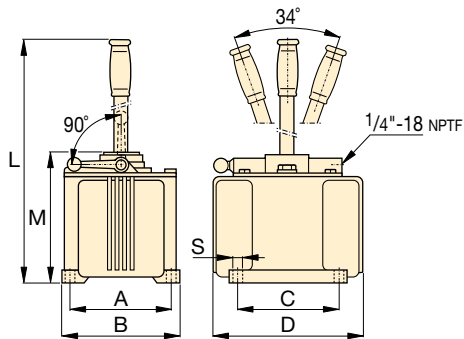

P-25, P-50

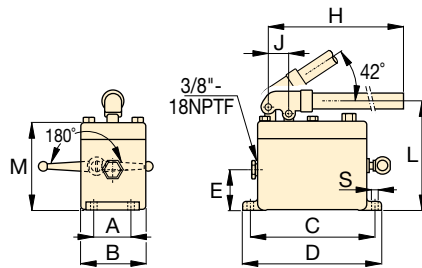

P-51

P-51 hand pumps used with RC-series cylinders to keep wooden layers under pressure during lamination of plates.



Hoses

Enerpac offers a complete line of high quality hydraulic hoses. To ensure the integrity of your system, specify only genuine Enerpac hydraulic hoses.

Page: **118**



| Piston Stroke | Dimensions (in) | | | | | | | | | | | | | | | | Weight (lbs) | Model Number | |
|---------------|-----------------|-------|------|------|------|---|-------|------|-------|------|------|---|---|---|-----|-----|--------------|--------------|-------------|
| | (in) | A | B | C | D | E | F | H | J | L | M | N | P | Q | R | S | | | T |
| .81 | 8.25 | 12.88 | 1.28 | 1.50 | 1.88 | - | 8.50 | 1.18 | 4.38 | .51 | 5.25 | - | - | - | - | - | - | 11 | P-18 |
| 1.50 | 6.00 | 6.82 | 6.00 | 9.43 | - | - | - | - | 26.94 | 7.88 | - | - | - | - | - | .40 | - | 36 | P-25 |
| 1.50 | 6.00 | 6.82 | 6.00 | 9.43 | - | - | - | - | 26.94 | 7.88 | - | - | - | - | - | .40 | - | 37 | P-50 |
| 1.00 | 2.06 | 3.63 | 7.12 | 7.88 | 2.25 | - | 24.00 | 1.16 | 6.31 | 5.06 | - | - | - | - | .34 | - | 12 | P-51 | |

Lightweight Hydraulic Foot Pump

▼ Shown: **P-392FP**



- **Robust, durable and compact**
 - Steel frame for maximum stability
 - Steel pumping handle
 - Aluminium reservoir
- **Foot pedal lock and lightweight construction for portability**
- **Two-speed operation reduces foot pedal strokes**
- **Large foot-pad release valve for controlling load descent**
- **Internal pressure relief valve for overload protection**

▼ *P-392FP offers the advantage of hands free operation to handle and control the tool or cylinder.*



P Series

Flow at Rated Pressure:

.15 in³/stroke

Reservoir Capacity:

38 in³

Maximum Operating Pressure:

10,000 psi

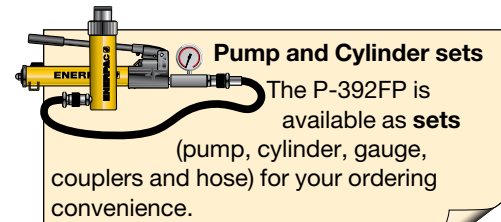

Page: **58**



Hoses

Enerpac offers a complete line of high quality hydraulic hoses. To ensure the integrity of your system, specify only genuine Enerpac hydraulic hoses.

Page: **118**

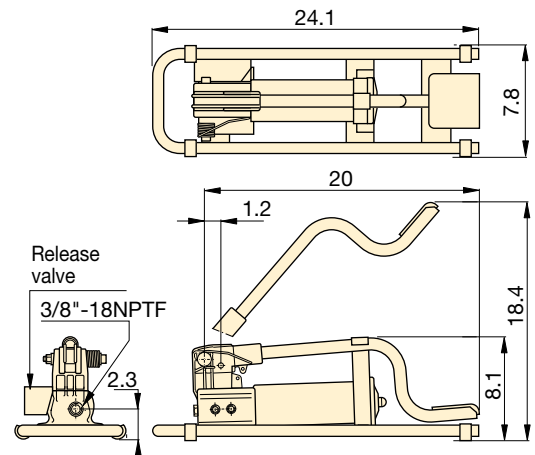

| Usable Oil Capacity (in ³) | Model Number | Pressure Rating (psi) | | Oil Displacement per Stroke (in ³) | | Max. Handle Effort (lbs) | Piston Stroke (in) | Weight (lbs) |
|---|------------------|--------------------------|-----------|---|-----------|-----------------------------|-----------------------|-----------------|
| | | 1st stage | 2nd stage | 1st stage | 2nd stage | | | |
| 38 | P-392FP * | 200 | 10,000 | .687 | .151 | 125 | 1 | 16 |

* Available as set, see note on this page.

Multifluid Hand Pumps

▼ Shown: **MP-110**



- Superior corrosion resistance
- Impregnated aluminium anodized pump housing with stainless steel internal pumping components
- Standard Nitrile seals – excellent for demineralized water, oil/water emulsions, water glycols, mineral oils, hydraulic fluids
- Custom EPDM seals available for use with Skydrol® or brake fluids
- Two speed pumps up to 14,500 psi pressure
- Externally adjustable pressure relief valve
- 1/4" NPTF gauge port

▼ *MP-Series pumps are ideal for testing and filling applications.*



MP Series

Reservoir Capacity:

2 gal. (optional)

Flow at Rated Pressure:

.12-1.28 in³/stroke

Maximum Operating Pressure:

1,500-14,500 psi



Optional Reservoir Kit

The 2 gallon reservoir kit **MP-10T** includes tank with skid frame, top plate with reservoir seal, suction pipe and mounting bolts. Useable oil capacity is 1.5 gal.

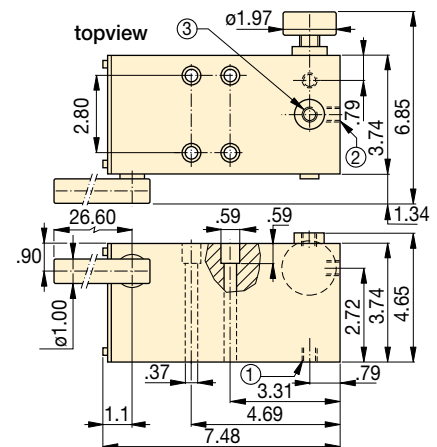

MP-110, 350, 700, 1000

- ① Suction / Tank return port 3/8"-18 NPTF
- ② Pressure port 3/8"-18 NPTF
- ③ Gauge port 1/4"-18 NPTF

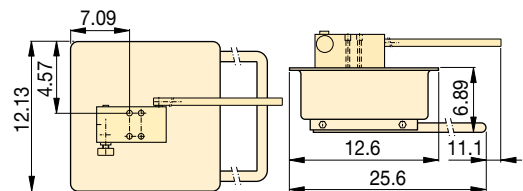

MP-10T

| Pump Type | Usable Oil Capacity (in ³) | Model Number | Pressure Rating (psi) | | Oil Displacement per Stroke (in ³) | | Max. Handle Effort (lbs) | Piston Stroke (in) | Weight (lbs) |
|-----------|--|----------------|-----------------------|-----------|--|-----------|--------------------------|--------------------|--------------|
| | | | 1st stage | 2nd stage | 1st stage | 2nd stage | | | |
| Two Speed | * | MP-110 | 500 | 1500 | 3.2 | 1.28 | 99 | 1.04 | 14.5 |
| | * | MP-350 | 500 | 5000 | 3.2 | .43 | 99 | 1.04 | 14.5 |
| | * | MP-700 | 500 | 10,000 | 3.2 | .18 | 99 | 1.04 | 14.5 |
| | * | MP-1000 | 500 | 14,500 | 3.2 | .12 | 99 | 1.04 | 14.5 |

Note: MP-Pump includes .060 in. thick gasket for reservoir mounting.

* MP-Series pumps require the use of an external reservoir.

▼ Shown from left to right: 11-100, P-2282



Ultra-High Pressure up to 40,000 psi



2-Way Shut-Off Valve 72-750

For 40,000 psi applications requiring a shut-off valve or gauge snubber. Made of 318 Stainless Steel and utilizing .38 inch cone fittings, it is the perfect selection for use with your Ultra-High Pressure Hand Pump.



Test System Gauges

Ideal for monitoring pressure in your hydraulic circuit, Test System Gauges, such as the T-6010L, are available with cone threads or NPTF threads and in a variety of pressure ranges.

Page: 128

- Two-speed operation on the P-2282 allows for faster fill, reducing cycle times for many testing applications
- 303 Stainless steel construction on the 11-100 and 11-400 models enable use with many different fluids, such as distilled water, alcohol, diesters, silicones, soluble oils and petroleum
- Large release knob for improved control of pressure release
- Outlet ports are 3/4"-16 cone for 40,000 psi rating

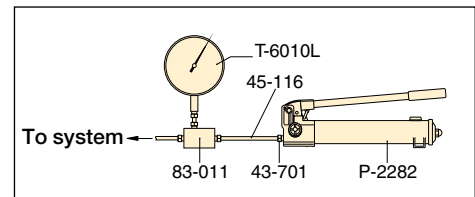

▲ Typical Test System

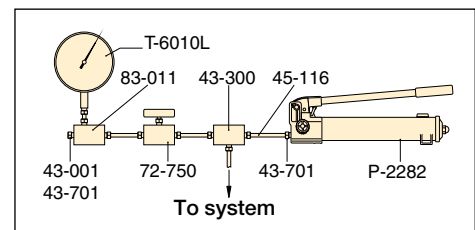

▲ Test System with Gauge and Snubber

Cone Seal

Stainless Steel High Pressure fittings seal on a "cone" surface and do not require pipe sealer. The Gland Nut holds the sleeve and tubing tight against the cone surface to provide a 40,000 psi seal.

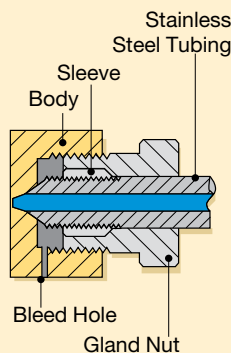

| Pump Type | Usable Oil Capacity (in ³) | Model Number | Pressure Rating* (psi) | | Oil Displacement per Stroke (in ³) | | Max. Handle Effort (lbs) |
|--------------|---|--------------|---------------------------|-----------|---|-----------|-----------------------------|
| | | | 1st stage | 2nd stage | 1st stage | 2nd stage | |
| Two-speed | 60 | P-2282 | 200 | 40,000 | .99 | .037 | 106 |
| Single-speed | 45 | 11-100 | N/C | 10,000 | N/C | .152 | 120 |
| | 45 | 11-400 | N/C | 40,000 | N/C | .038 | 120 |

* Contact Enerpac for applications where operating pressure is less than 10% of pressure rating.

Ultra-High Pressure Hand Pumps

▼ Optional Ultra-High Pressure Fittings and Tubing

| Description | Connection | Model No. |
|------------------------|---|----------------------------|
| 40,000 psi | | |
| Gland Nut Plug | .38" cone | 43-001 |
| Elbow | .38" cone | 43-200 |
| Tee | .38" cone | 43-300 |
| Gauge Tee | .38" cone side/ .25" cone gauge port | 43-301 |
| Gauge Adaptor | .38" cone side/ .25" cone gauge port | 83-011 |
| Coupling | .38" cone | 43-400 |
| Cross | .38" cone | 43-600 |
| Gland Nut with Sleeve | .38" cone | 43-701 |
| Gauge Connector | .25" cone | 43-704 |
| Tubing | 4" tube, O.D. .38" * 8" tube, O.D. .38" * 12" tube, O.D. .38" * | 45-116 45-126 45-136 |
| 10,000 psi only | | |
| Adaptor | .38" F cone to 1/4" M NPTF | 41-146 |
| | .38" F cone to 3/8" M NPTF | 41-166 |
| Adaptor | .38" F cone to 1/4" F NPTF | 41-246 |
| | .38" F cone to 3/8" F NPTF | 41-266 |
| Adaptor | .38" M cone to 3/8" F NPTF | 41-366 |

Note: .25" cone fittings use 9/16"-18 threads, 3/8" cone fittings use 3/4"-16 threads.

* Actual tubing lengths are .75" less than nominal size shown. These dimensions make distance between centers of valves and fittings multiples of 4" spaces.

P/11 Series



Reservoir Capacity:

45-60 in³

Flow at Rated Pressure:

.037-.152 in³/stroke

Maximum Operating Pressure:

10,000-40,000 psi



Stainless Steel Construction

Ultra-high Pressure Fittings feature all stainless steel construction except adaptor 41-366, which features nickel plated carbon steel construction.

Optional T-Series gauge and fitting

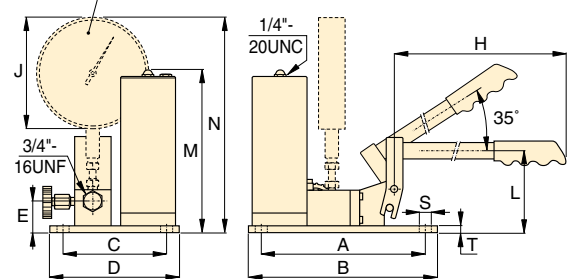

11-100, 11-400

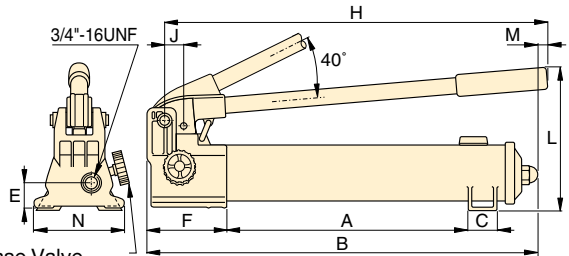

Release Valve
P-2282

| Piston Stroke | Dimensions (in) | | | | | | | | | | | | | | Weight (lbs) | Model Number |
|---------------|-----------------|-------|------|------|------|------|-------|------|------|------|-------|-----|-----|----|--------------|--------------|
| | A | B | C | D | E | F | H | J | L | M | N | S | T | | | |
| 1.00 | 13.56 | 22.00 | 1.40 | - | 1.24 | 5.25 | 20.75 | 1.16 | 9.00 | .28 | 4.74 | - | - | 14 | P-2282 | |
| .78 | 9.45 | 10.50 | 5.98 | 7.00 | 1.77 | - | 25.00 | 6.41 | 4.50 | 9.33 | 12.38 | .31 | .37 | 22 | 11-100 | |
| .78 | 9.45 | 10.50 | 5.98 | 7.00 | 1.77 | - | 25.00 | 6.41 | 4.50 | 9.33 | 12.38 | .31 | .37 | 22 | 11-400 | |